

Canadian Mapping

Grades 2-3

Written by Lynda Golletz
Illustrated by S&S Learning Materials

About the Author:

Lynda Golletz was an elementary school teacher for thirty-three years. She is the author of many educational resources for teachers and students. Ms Golletz has travelled across Canada several times.

ISBN 978-1-55495-030-0
Copyright 2009

Published in Canada by:
S&S Learning Materials
15 Dairy Avenue
Napanee, Ontario
K7R 1M4
www.sslearning.com

Permission to Reproduce

Permission is granted to the individual teacher who purchases one copy of this book to reproduce the student activity material for use in his/her classroom only. Reproduction of these materials for an entire school or for a school system, or for other colleagues or for commercial sale is strictly prohibited. No part of this publication may be transmitted in any form or by any means, electronic, mechanical, recording or otherwise without the prior written permission of the publisher. "We acknowledge the financial support of the Government of Canada through the Book Publishing Industry Development Program (BPIDP) for this project." Printed in Canada. All Rights Reserved

At A Glance

Learning Expectations

	Canada's Shape and Location on Globes and Many Maps	Many Kinds of Maps	Symbols, Legends, Scale, Directions, Colour, Grids	Continents, provinces and territories	Games, Word Sort	Mapping Kitchen and Aquaplex	Canada's Landforms and Oceans	Urban and Rural Communities	Water Words, Word Sort
Understanding Concepts									
• Recognize that the world is made up of countries, continents and regions	•	•	•	•				•	
• Recognize Canada as part of North America	•	•	•	•				•	
• Identify a variety of maps and locate Canada on them	•	•	•	•				•	
• Identify a variety of maps and their uses	•	•	•	•					
• Identify earth as a sphere, half the earth as a hemisphere, and demonstrate an understanding that the globe is a model of the earth	•	•							
• Recognize that maps represent real places	•	•		•		•	•	•	•
Map and Globe Skills									
• Make and read pictorial and simple maps to locate information	•	•	•	•		•	•	•	•
• Recognize and use pictorial symbols, colour, legends, keys, and cardinal and intermediate directions on maps of Canada	•	•	•	•	•		•		
• Use standard units to measure distance on a map (scale)			•						
• Use own symbols on a map			•	•		•			
• Recognize the major parallels of latitude	•	•	•		•				
• Recognize the major meridians of longitude	•	•	•						
• Recognize that different colours represent different things on maps	•	•	•	•		•	•		•
• Make and read maps of familiar areas in their own environment			•			•		•	
• Locate Canada's provinces and territories				•			•		
• Identify major landforms of Canada							•		
• Locate oceans near Canada							•		
Inquiry/Research Communication Skills									
• Recognize urban and rural communities		•						•	
• Use maps to locate information about their own community and provinces and territories	•	•	•	•			•	•	•
• Compare provinces and territories	•	•		•			•		
• Make and read maps of their local community		•	•				•	•	
• Sort and classify information obtained from maps	•	•	•	•	•		•	•	•
• Read a variety of maps to obtain information	•	•	•	•			•	•	•

Table of Contents

At A Glance™	2
Teacher Rubric	5
Student Rubric	6
Teacher Information	7
Glossary of Geographic Terms	12

CANADA'S SHAPE AND LOCATION

Canada in the World - 1 (Locating Canada on a World Map)	15
Canada in the World - 2 (Locating Canada on a World Map)	16
Canada in North America (Map of North America)	17
Our Country Canada (Map)	18
Canada on a Globe - 1 (Locate Canada and the Hemispheres)	19
Canada and the Hemispheres (Find the Equator and Hemispheres)	20
Canada Sort (Read and Interpret Globe: Find Equator, Poles, and Hemispheres)	21
Canada on Many Maps - 1 (Locate Canada on Different Maps)	22
Canada on a Globe - 2 (Locate Canada on a Variety of Globe Representations)	23
The Continents (Locate Continents on Globes)	24
Canada from Space! (Satellite Image)	25
Explore Canada From Space (Internet Activity)	26

CANADA MAPS AND MAP FEATURES

Neighbourhood Map (Map Legend and Symbols)	27
Pictures, Maps, and Symbols (How Symbols are Helpful)	28
Mapping Our Kitchen - Making Symbols (Create Own Symbols)	29
A Map of My Kitchen (Create a Map Using Symbols)	30
Canadian Cities - Using Symbols (Symbols for Cities on a Map)	31
Finding Canadian Cities - Using Symbols (Locating Canadian Cities)	32
Compare Two Provinces - Using Symbols (Symbols can Provide Information)	33
Compare Two Territories - Using Symbols (Symbols can Provide Information)	34
Colours on a Map (Colour Denotes Political Boundaries)	35
Colouring Canada (Colour on a Map of Canada)	36
What Way? (Using Cardinal and Intermediate Directions)	37
My Pencil's Journey - All Around Canada (Using Cardinal and Intermediate Directions) ..	38
Using a Map Legend - Map of Canada - 1 (Interpreting Symbols on a Canada Map) ..	39
Using a Map Legend - Map of Canada - 2 (Interpreting Symbols on a Canada Map) ..	40
Be an Aquaplex Designer! (Draw a Simple Map with Specific Elements)	41
My Aquaplex Design (Draw a Simple Map with Specific Elements)	42
Map of Canada - Measuring Distance - Using Scale (Using Standard Units of Scale)	43
Map of Ontario - Measuring Distance - Using Scale (Using Standard Units of Scale)	44

Map of Quebec and Labrador - Measuring Distance - (Scale Using Standard Units) ...	45
Canada's Funland - Using Map Scale (Use Simple Scale with Standard Units)	46
What Are Those Lines? (Parallels of Latitude)	47
Parallels of Latitude (Map of Canada)	48
Find the Equator and the Poles on a Globe (Teacher Page)	49
Globe Exercises (Game)	50
Up and Down - Introducing Longitude (Introduction)	51
Using Meridians of Longitude on a Map of Canada (Canada Mapping Skill)	52
Canada on Many Maps - 2 (A Variety of Maps and Their Uses)	53
Canada on Many Maps - 3 (A Variety of Maps and Their Uses)	54
Mapping Canada (Getting Information from Maps)	55
More Mapping Canada (Getting Information from Maps)	56

CANADA'S PROVINCES AND TERRITORIES

Canada's Provinces and Territories (Names and Shapes of Provinces and Territories) ..	57
Canada's Provinces and Territories (Names and Shapes of Provinces and Territories) ..	58
The Names and Shapes of the Provinces and Territories of Canada	59
The Names and Shapes of the Provinces and Territories of Canada (Games)	60
The Names and Shapes of the Provinces and Territories of Canada (Games)	61
Canadian Mapping Game Ideas For the Teacher (Teacher Page)	62
Province and Territory Sort (Interpreting a Map)	63

MAJOR LANDFORMS AND BODIES OF WATER IN CANADA

Landforms of Canada (Interpreting Physical Features of Canada)	64
Are You Planning a Trip? (Interpreting Physical Features of Canada)	65
The Oceans (Label the Oceans Around Canada)	66
Canada's Big Water (Recognizing Canada's Major Bodies of Water)	67
Be a Water Detective! (Recognizing Canada's Major Bodies of Water)	68
Ontario's Big Water (Recognizing Ontario's Major Bodies of Water)	69
Ontario's Landforms (Interpreting Physical Features of Ontario)	70
Landforms of British Columbia (Interpreting Physical Features of British Columbia) ...	71
Comparing Two Provinces (Using a VENN Diagram)	72

CANADIAN COMMUNITIES - URBAN AND RURAL

Where I Live (Locate Local Community on a Globe)	73
Physical Map of Canada (What is it like near my community?)	74
My Canadian Community (What is it like near my community?)	75
Urban and Rural Communities - 1 (Comparing Urban and Rural Communities)	76
Urban and Rural Communities - 2 (Comparing Urban and Rural Communities)	77
A Car Trip in Canada (Urban and Rural)	78
Answer Key	79

Teacher Rubric Canadian Mapping Grades 2 and 3

Student's Name: _____ Date: _____



Criteria	Level 1	Level 2	Level 3	Level 4
Can recognize the shape of Canada on a variety of maps.	Not at all	Just on basic map	On a variety of maps if usual orientation	On a variety of maps and in a variety of orientations
Demonstrates knowledge of Canada within North America.	Not at all	Just on basic map	On a variety of maps if usual orientation	On a variety of maps and in a variety of orientations
Demonstrates knowledge of maps as representing real places.	Little evidence	Some evidence	Good evidence	Excellent evidence
Names and locates Canada's provinces and territories.	Not at all	Some evidence	Good evidence	Excellent evidence
Identifies earth as a sphere, half the earth as a hemisphere, and demonstrates an understanding that the globe is a model of the earth.	Not at all	Some evidence	Good evidence	Excellent evidence
Locates equator, prime meridian, and major parallels of latitude.	Much difficulty	Can with a great deal of assistance	Can with a little assistance	Excellent and with almost no assistance
Makes and reads simple maps to locate information.	Much difficulty	Can with a great deal of assistance	Can with a little assistance	Excellent and with almost no assistance
Uses appropriate map vocabulary.	Little evidence	Some evidence	Good	Excellent
Recognizes and uses pictorial symbols, colour, legends, keys, and cardinal and intermediate directions on maps of Canada.	Little competency	Some competency	Satisfactory competency	Excellent competency
Locates local community on a map of Canada.	Not at all	Some competency with assistance	Some competency with a little assistance	Excellent competency
Identifies urban and rural locations and can site their differences.	Not at all	Some competency with assistance	Some competency with a little assistance	Excellent competency
Identifies the continents.	Not at all	Some competency with assistance	Some competency with a little assistance	Excellent competency

Student Self-Assessment Rubric

Name: _____

Date: _____

In the box, draw the face that best describes your performance. Then, add your points to determine your total score.

Expectations	Needs Improvement (1 point) 	Sometimes (2 points) 	Always/ almost always (3 points) 	My Points
I can find Canada on many maps.				
I can find places on a Canada map.				
I can draw symbols.				
I can make tidy maps.				
I can use a map legend/key.				
I colour and label maps well.				
I can use the map scale.				
I can follow the Compass Rose directions.				
I can name three or more maps and their uses.				



Canada in the World-1

A **map** is a picture of a place. This is a **political** map. It shows the names of the continents. This map shows all of our world. We can use this map to see where Canada is in the world.

1. Colour all of the **water** blue.
2. Colour **Canada** red.
3. Colour all of the other land green.

The World

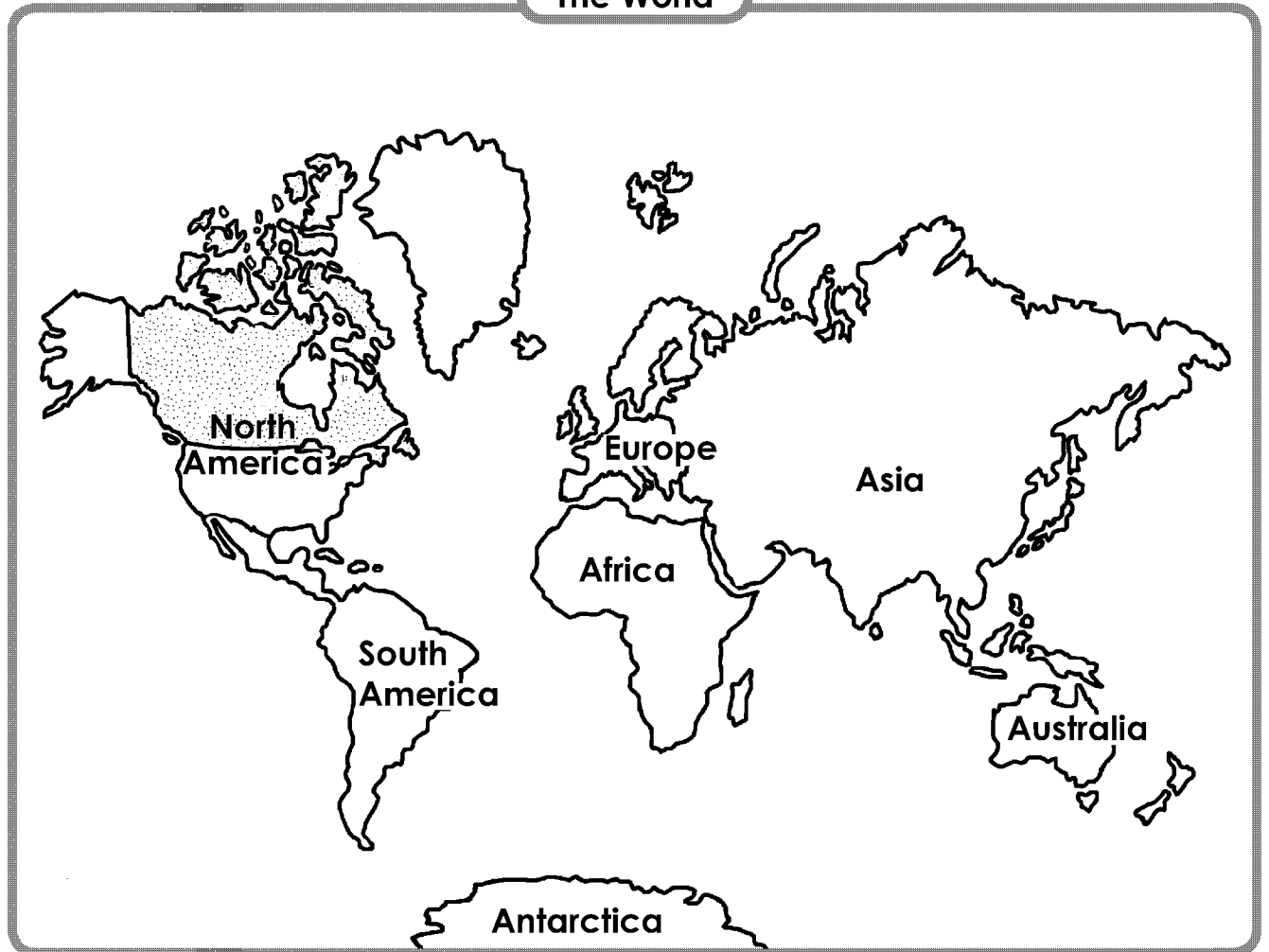

Canada in the World - 2

1. Print the names of the continents in the correct places on the lines.

North America, South America, Europe, Asia, Africa, Australia, Antarctica

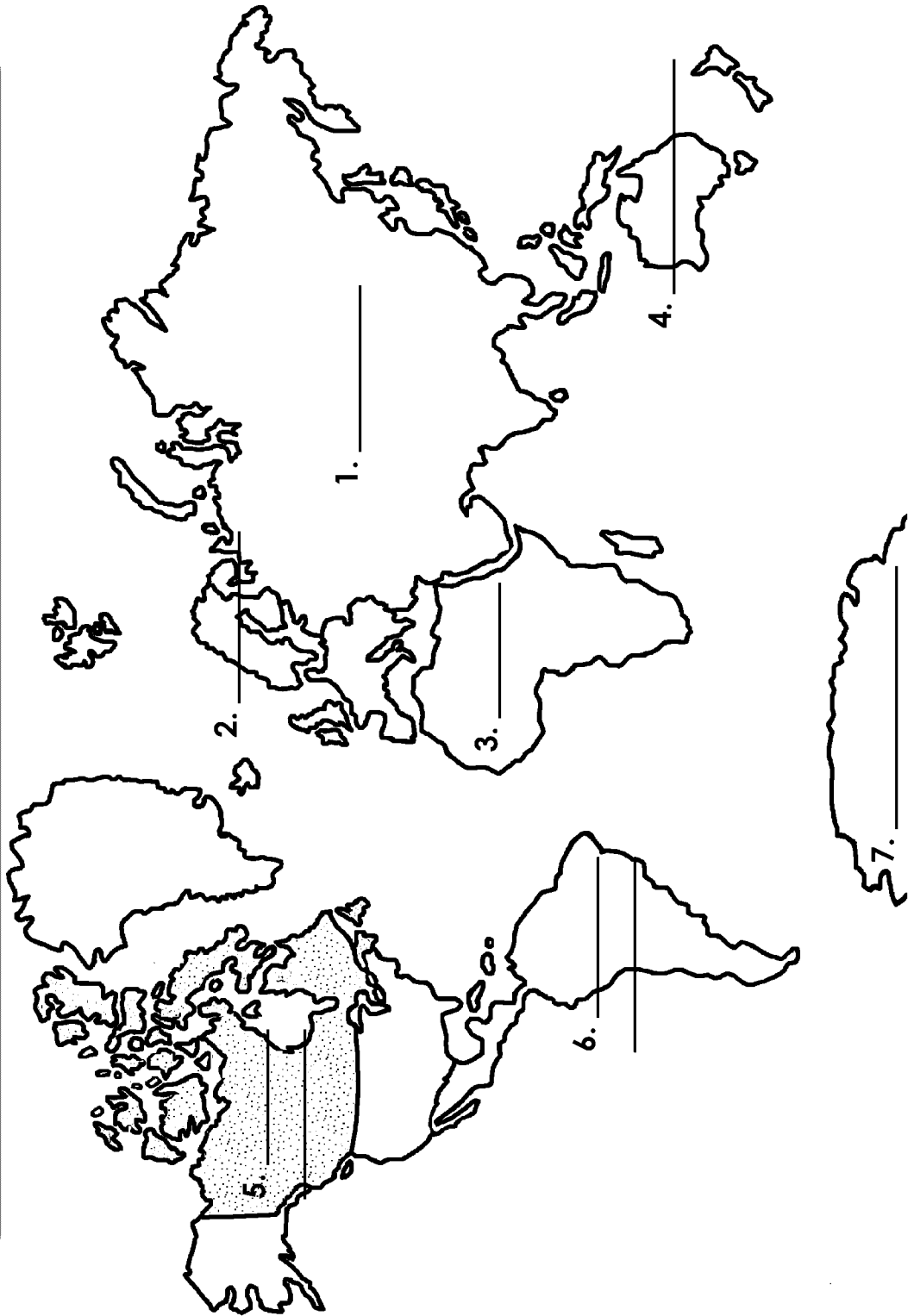



Neighbourhood Map - Map Legend and Symbols

Symbols on maps are drawings, letters or figures that represent places or features.

A **Legend** is sometimes called a **Key**.

It is the part of a map that explains the symbols used on it.

In the Legend below, draw a symbol beside each word.

Then, draw the symbols beside their numbers on the map.

Legend

- | | | | | | | | | |
|---|--------------------------|------------|---|--------------------------|-------------|---|--------------------------|----------------|
| 1 | <input type="checkbox"/> | school | 4 | <input type="checkbox"/> | church | 7 | <input type="checkbox"/> | library |
| 2 | <input type="checkbox"/> | house | 5 | <input type="checkbox"/> | hospital | 8 | <input type="checkbox"/> | police station |
| 3 | <input type="checkbox"/> | apartments | 6 | <input type="checkbox"/> | flower shop | 9 | <input type="checkbox"/> | post office |

Map

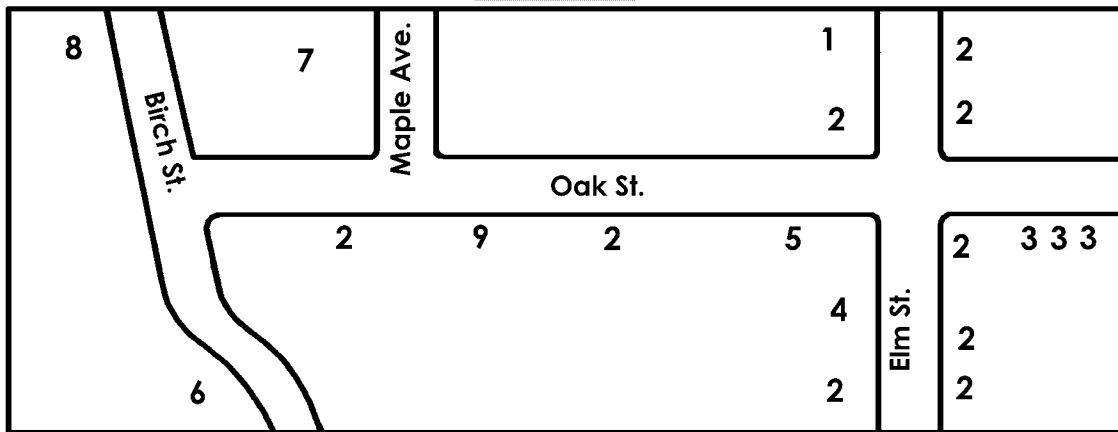

Name the Streets

- Apartment Buildings _____
- Houses _____
- School _____
- Church _____
- Post Office _____
- Library _____
- Flower Shop _____



Pictures, Maps and Symbols

This is a picture of a bedroom.

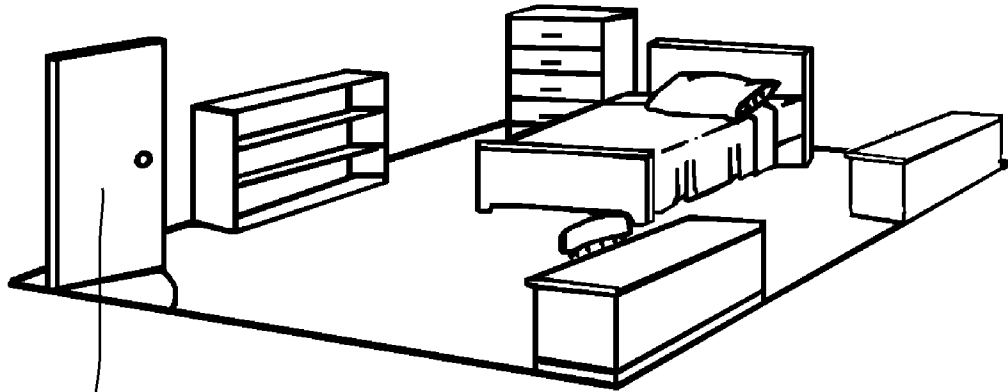

This is a map of the same bedroom. It shows a "bird's-eye view."

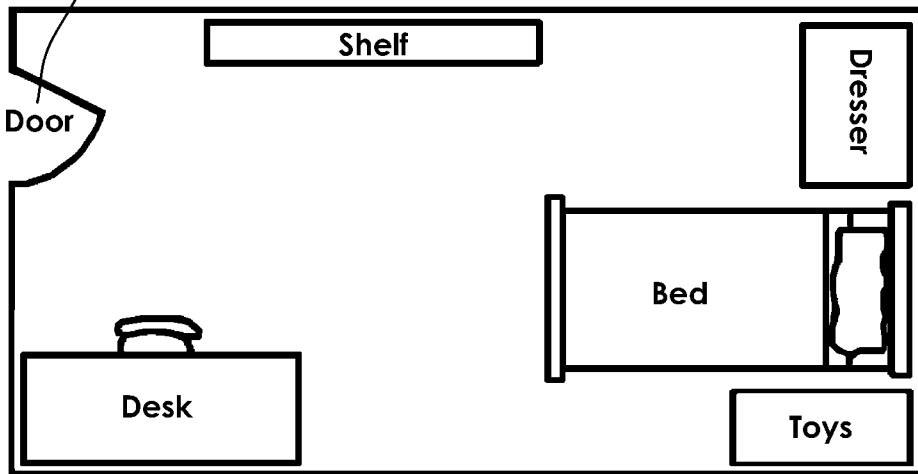

Draw lines from picture to map. The first one is done for you.

Draw the correct symbol beside each word in the Legend/Key.

Legend

1



Shelf

4



Door

2



Dresser

5

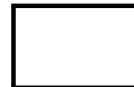

Desk

3



Bed

6



Toy Box